

Richard Steinitz Building

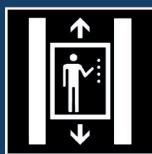

Refuge area



Lift



Refuge area with communications

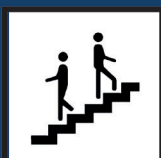

Stairs



Accessible toilet left-hand transfer



Accessible toilet right-hand transfer



Accessible toilet with changing facilities



Main entrance and exit door

Richard Steinitz Building Floor G

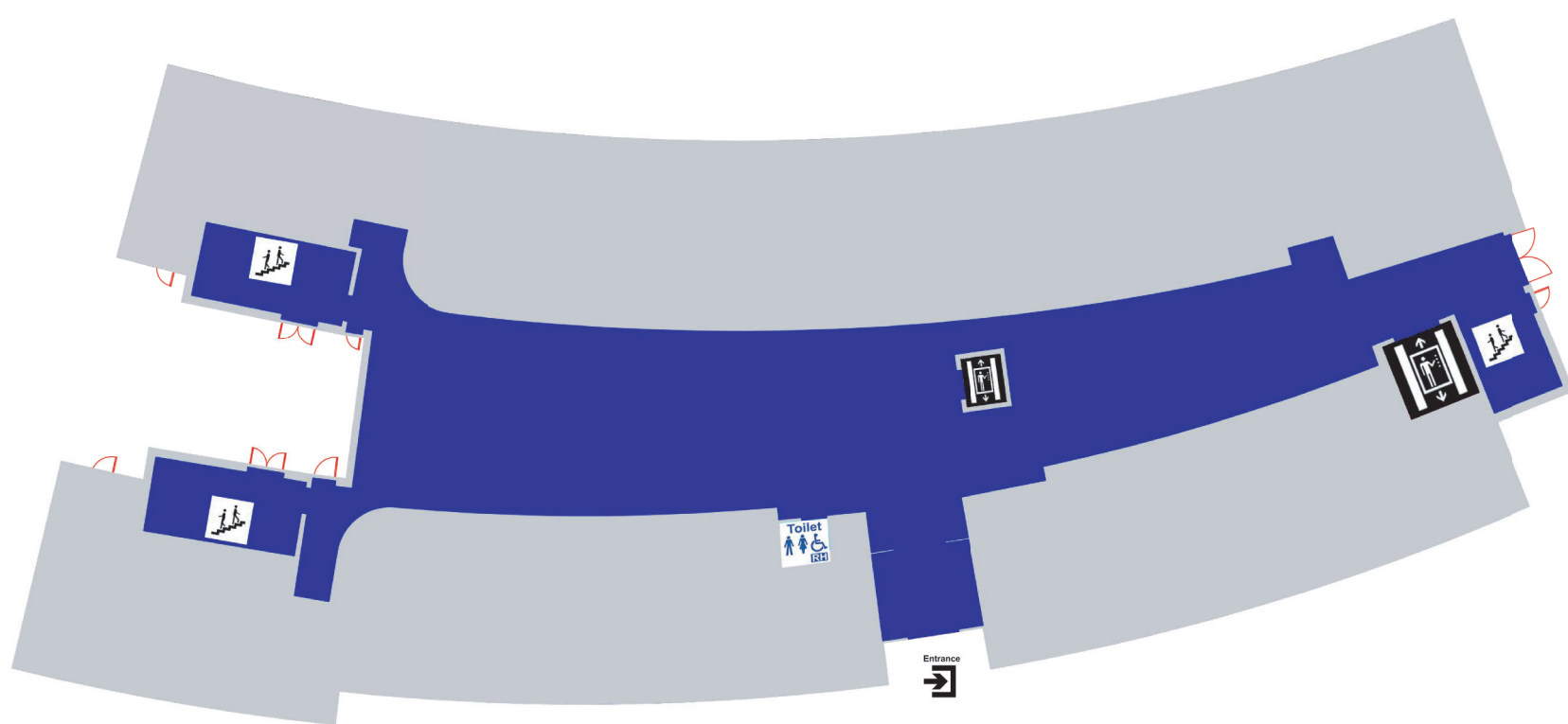

Richard Steinitz Building - Ground

Richard Steinitz Building Floor 1

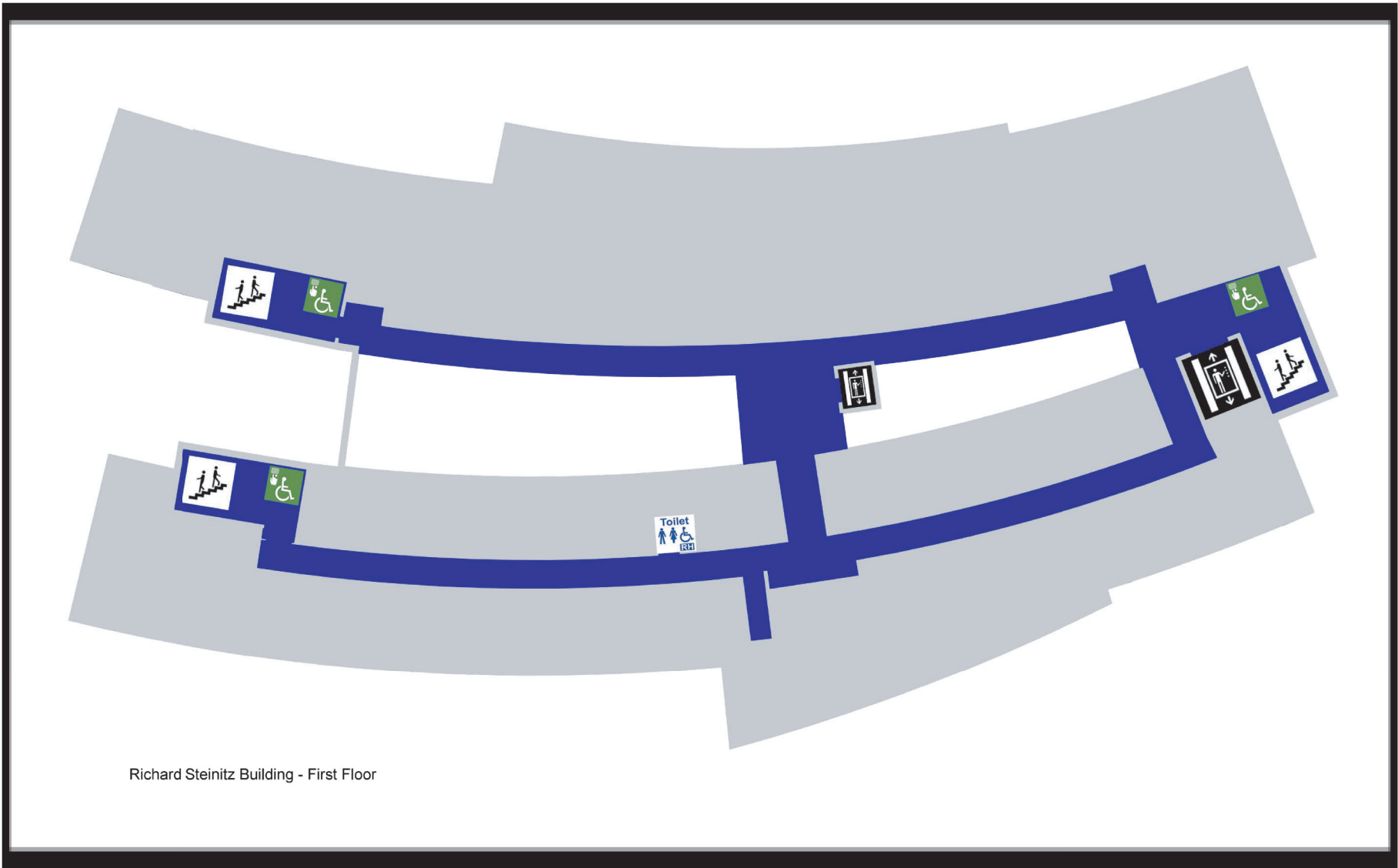

Richard Steinitz Building - First Floor

Richard Steinitz Building Floor 2

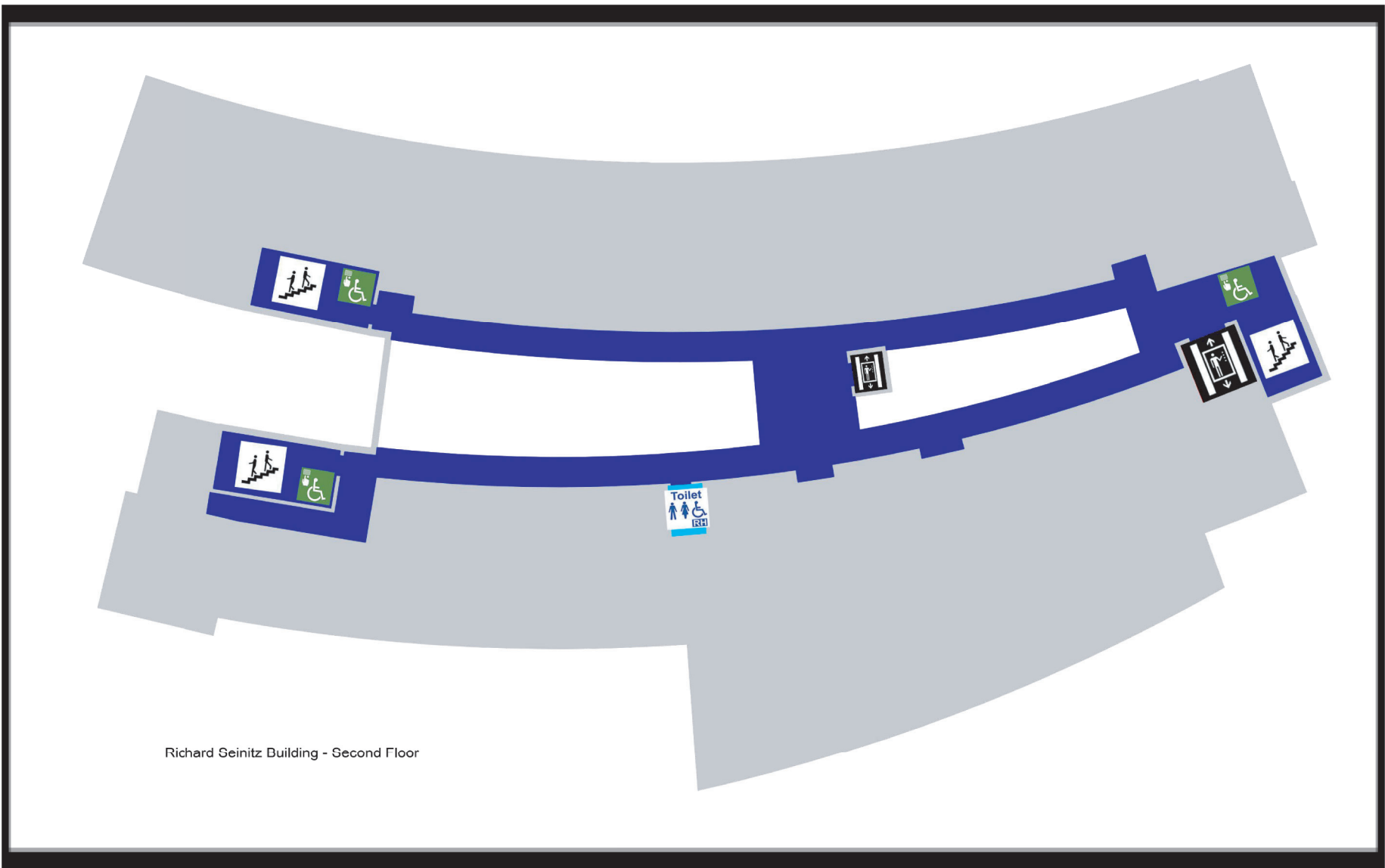

Richard Seinitz Building - Second Floor

Richard Steinitz Building Floor 3

